

**CIVIL DEMOLITION PLAN**

SCALE: 1" = 10'

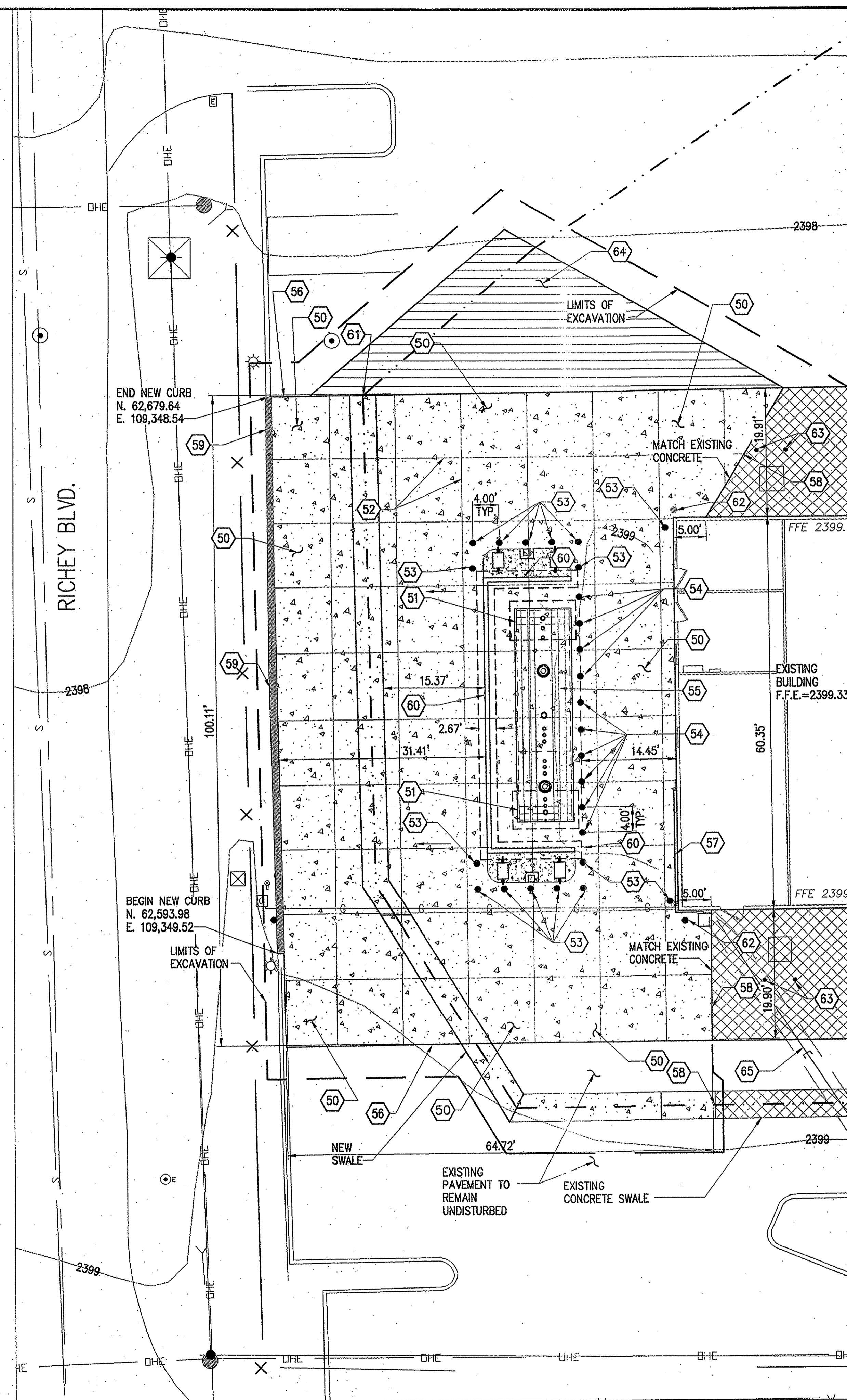

**CIVIL SITE IMPROVEMENT PLAN**

SCALE: 1" = 10'



**DEMOLITION KEY NOTES**

1. EXISTING PAVEMENT TO BE REMOVED.
2. EXISTING WATER & COMPRESSED AIR LINES TO BE REMOVED. SEE MP101.
3. (2) EXISTING 15,000 GALLON U.G. FUEL TANKS & APPURTENANCES TO BE REMOVED. CONTRACTOR TO FOLLOW ADEQ UST REMOVAL PROCEDURES. SEE SHEET MD101.
4. EXISTING CONCRETE TO BE REMOVED.
5. REMOVE ALL CONCRETE & ASPHALT WITHIN SAW CUT LIMITS.
6. EXISTING SOIL AROUND TANK TO BE REMOVED & DISPOSED OF LEGALLY. PER ADEQ UST REMOVAL REQUIREMENTS.
7. HOLE TO BE BACKFILLED WITH ENGINEERED FILL, COMPACTED IN 10" LIFTS MEETING A MINIMUM 97% DENSITY TEST. ALL LIFTS TO BE INSPECTED BY 3rd PARTY TESTING AGENT.
8. REMOVE ALL UNDERGROUND ELECTRICAL WIRING & CONDUIT. CONTRACTOR TO VERIFY LOCATION PRIOR TO CONSTRUCTION.
9. DEMO EXISTING OIL LINE.
10. EXISTING GRAVEL, DEBRIS & CONCRETE WASTE TO BE REMOVED.
11. EXISTING CONCRETE ISLAND FUEL DISPENSERS & BOLLARDS TO BE REMOVED.

**SITE IMPROVEMENT KEY NOTES**

50. NEW 6" CONCRETE SLAB W/ #4 @ 16" O.C. EACH WAY ON 4" ABC PER DETAIL 1/C1501. SLOPE AWAY FROM FUEL TANK @ 0.5% MIN.
51. NEW CONCRETE TANK SUPPORT PIER. SEE SB101.
52. CONTROL JOINTS 12' O.C. PER DETAIL 3/C1501.
53. INSTALL (14) BOLLARDS PER DETAIL 4/C1501.
54. INSTALL (10) BOLLARDS PER DETAIL 5/C1501.
55. NEW 12,000 GALLON ABOVE GROUND FUEL TANK. SEE MP501.
56. SAWCUT TRIM, TACK, & JOIN NEW CONCRETE TO EXISTING PAVEMENT. SEE DETAIL 9/C1501.
57. NEW WATER LINE. SEE MP101.
58. SAWCUT, TRIM, TACK AND JOIN TO EXISTING CONCRETE.
59. NEW 6" CURB. SEE DETAIL 7/C1501.
60. NEW CMU WALL & FOOTING. SEE SB101.
61. NEW CONCRETE SWALE. JOIN NEW CONCRETE TO PAVEMENT SEE DETAIL 8/C1501.
62. REMOVE & REPLACE BOLLARD.
63. EXISTING BOLLARD TO REMAIN.
64. NEW ASPHALT PAVEMENT 2.5" A.C./4" A.B.C. TO MATCH EXISTING PAVEMENT. SEE DETAIL 6/C1501.
65. NEW ELECTRICAL, SEE SHEET EP101.

**MATERIALS LEGEND**

|                                 |  |
|---------------------------------|--|
| EXIST. CONCRETE TO REMAIN       |  |
| EXISTING CONCRETE TO BE REMOVED |  |
| EXISTING PAVEMENT TO BE REMOVED |  |
| EXISTING GRAVEL TO BE REMOVED   |  |
| NEW PAVEMENT                    |  |
| NEW CONCRETE                    |  |



**RICHEY BLVD. FUEL TANK REPLACEMENT**

**PIMA COUNTY**  
FACILITIES MANAGEMENT  
150 WEST CONGRESS 5TH FL.  
TUCSON, AZ 85701

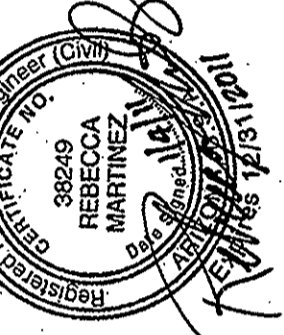

2051 W. SUNSET RD.  
SUITE NO. 101  
TUCSON, ARIZONA 85704  
TEL: (520) 293-4488  
FAX: (520) 293-8349  
WWW.M3PN.COM

ARCHITECTURE  
ENGINEERING  
CONSTRUCTION MANAGEMENT

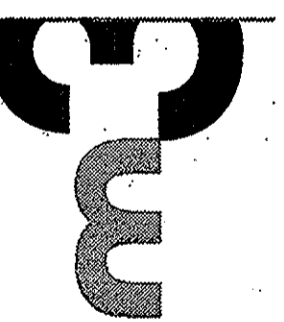

**Revisions**

| Description | Date |
|-------------|------|
|             |      |
|             |      |
|             |      |
|             |      |
|             |      |

Drawn: DEJ  
Checked: WB  
Issue Date: 12-11-2010

Drawing Title  
**CIVIL DEMOLITION SITE IMPROVE PLAN**

Sheet Number

**C1101**

M3PN 100100

Last Update: 1.4.2011